

THE BENSON



Elevation A



Elevation B

HOME FEATURES:

- > 3 Bedroom, 2 Bath or 4 Bedroom, 2.75 Bath
- > 3 Car Garage
- > 9 Foot Ceilings
- > Huntwood Custom Cabinets Throughout
- > Quartz or Granite Kitchen Counters
- > Stainless Steel Appliances
- > Walk-In Pantry
- > White Painted Millwork Throughout
- > Main Floor Master Suite with Spa Master En-Suite
- > Upper Floor Bonus Space with Optional Forth Bedroom
- > Outdoor Covered Patio
- > Full Landscaping and Fencing

SQUARE FOOTAGE:

Elevation A = 2,716 SF

Elevation B = 2,716 SF



The one and a half level Benson offers a main floor sanctuary master suite with five-piece bath, including a soothing free-standing tub, tile surround shower, and double-sink vanity. Two bedrooms and large full bath off the warm hardwood flooring of the foyer hallway. Natural light bathes the vaulted great room, cozied up by a stylish fireplace that also warms the centrally designed gourmet kitchen. Quartz or granite surface island, impeccable stainless appliances make meal preparation feast-worthy. An open-air covered outdoor living area

connects via magnificent sliding glass doors to embrace the Northwest's distinctive seasons. When needed, a bonus space for rec room potential and optional fourth bedroom are upstairs.

❖ Available on Lots 5, 10 & 11 - Lot 11 Includes Bonus Bed/Bath on Upper Level & Heat Pump Installed

For more information call: 425-736-6020

Or visit: www.hhiwillowplace.com

Hultquist Homes, Washington Division - Represented By:



Dianne Masaoka - 425.736.600
email: diannem@windermere.com



www.HultquistHomes.com

THE BENSON



MAIN FLOOR

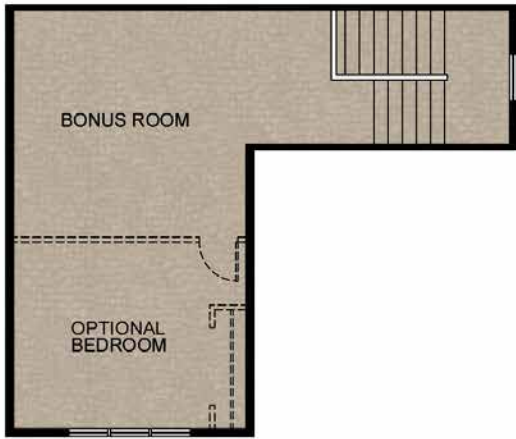

UPPER FLOOR

*Lot 11 Includes Bonus Bed/Bath on Upper Floor

For more information call: 425-736-6020

Or visit: www.hhiwillowplace.com

Specifications and finish choices subject to change without notice. Images, maps and diagrams depict home as artist's concept rendering. Dimensions and square footages are approximate.

Hultquist Homes, Washington Division - Represented By:



Dianne Masaoka - 425.736.600
email: diannem@windermere.com



www.HultquistHomes.com